

2 WAY AUTO SWING GATE



SCOPE OF OPERATION

- The most versatile automatic opening gate in the market place. When used in conjunction with our standard posts and rails provides an access control solution for an entrance or exit direct.
- When the gate is pushed in an unauthorized direction, an alarm sounds alerting staff to a potential shop lifting. Easy to configure for new customer layouts and can be integrated into existing systems.
- In the event of power loss gate arm moves freely in both directions.

MATERIALS

All materials meet the ASTM standards as set forth by the materials industry.

- The gate post is constructed out of 1/8" wall, 4.5" dia DOM tube.
- Arm closing controlled by motor.
- Standard gate arm lengths for ADA compliant.
- Complete with white ABS sign panel and channels to hold sign or rubber coated arm.
- Anchor bolts are hidden by cover which snaps over the floor mounting flange.
- Custom gate arm length can be fabricated.

FINISHES

- Bright Chrome.
- Stainless Steel.

OPERATION

- Allows for left hand or right hand operation.
- Adjustable gate mounted miniature radar approach sensor.
- Audible generic alarm.
- One or two way passage.
- Anti-panic breakaway arm.
- Standard universal sign.
- Manual key switch operation enables deactivation of the gate if required.
- Adjustable gate opening time to suit individual requirements.
- Adjustable opening and closing speed.
- Adjustable volume for audible signal.
- Direction change easily done in the field.
- Power input connection at the bottom or top of gate.

OPTIONS

- Push button control.
- Custom signage.
- Can be linked to fire alarm system.
- Computer interface for card access.
- Wireless remote control.

ELEVATION DIAGRAM – SINGLE GATE LAYOUT

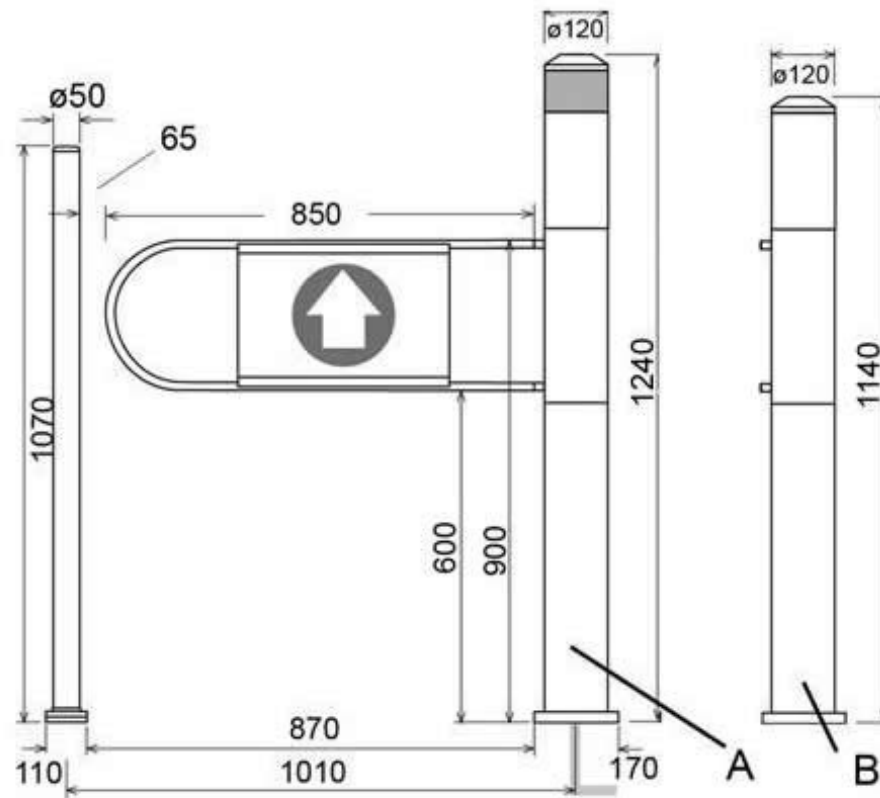

ELEVATION DIAGRAM – DOUBLE GATE LAYOUT

